

# PolyGrip<sup>®</sup> rivets

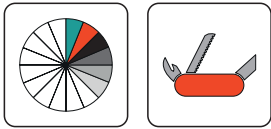
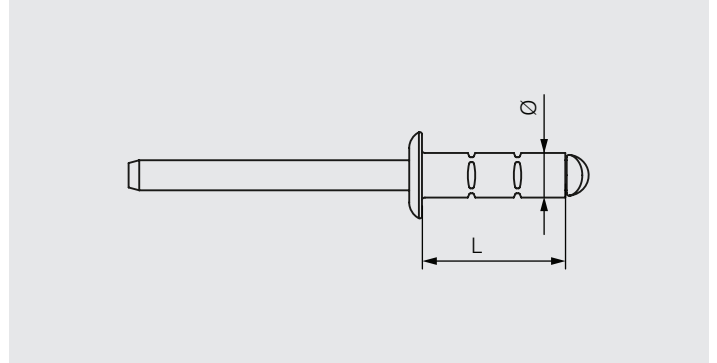
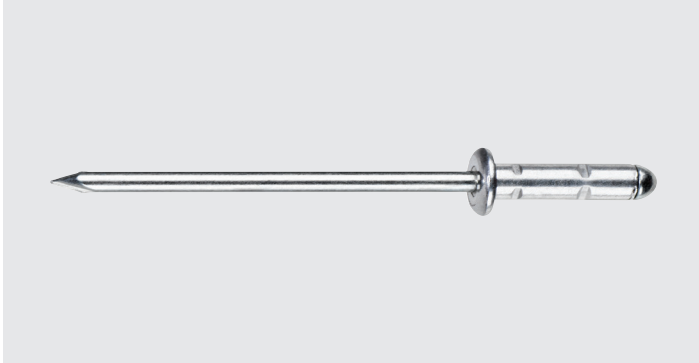

## Application

Joining metal to metal in side lap and flashing details

## Component 1 (t<sub>I</sub>)

–

## Component 2 (t<sub>II</sub>)

–

$\Sigma_{\max} t_I + t_{II}$

See KL  
in table

## Fastener material

ST = Steel

AL = Aluminium

A2 = Stainless Steel A2

A4 = Stainless Steel A4

## Approvals

ETA-13/0255

## Features and Benefits

- A wide grip range: A single PolyGrip<sup>®</sup> blind rivet can be a substitute for up to five different lengths of standard blind rivets.
- Outstanding hole filling capability: The rivet body expands radially during the setting process and compensates hole tolerances, centering deviations and differences in diameter, thus always giving a tight joint.
- Safe rest mandrel locking: PolyGrip<sup>®</sup> blind rivets neither generate rattling noises due to free moving rest mandrels nor do they allow it to fall off due to its encaging closing head and internal mandrel lock.
- Splashproof and water resistant: Hole filling and rest mandrel locking make them a real alternative to closed end rivets when it is essential to prevent water flowing through the whole joint and not only through the rivet body.
- A large head: for a high tensile and pull through resistance.

## Documentation

Approval document (ETA) | Declaration of performance (DoP)

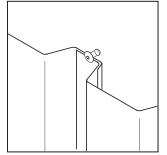

## Rivets in aluminium onto steel and aluminium

Product code	L	Ø	KL	Body material	Mandrel material	Pilot hole	
PG-C A4A4 4,8X10,0 F	10.0	4.8	1.0-6.5	SS A4	SS A4	4.9	1433923
PG-C A4A4 4,8X15,0 F	15.0	4.8	5.0-10.0	SS A4	SS A4	4.9	1433924
PG-C ALA2 4,8X10,0 F "CE"	10.0	4.8	0.5-6.5	Aluminium	SS A2	4.9	1433892
PG-C ALA2 4,8X15,0 F "CE"	15.0	4.8	4.5-11.0	Aluminium	SS A2	4.9	1433893
PG-C ALA2 4,8X17,0 F "CE"	17.0	4.8	6.5-13.0	Aluminium	SS A2	4.9	1433894
PG-C ALA2 4,8X17,0 F K16,0 "CE"	17.0	4.8	6.5-13.0	Aluminium	SS A2	4.9	1433899
PG-C ALST 4,8X10,0 F "CE"	10.0	4.8	0.5-6.5	Aluminium	Steel	4.9	1433831
PG-C ALST 4,8X15,0 F "CE"	15.0	4.8	4.5-11.0	Aluminium	Steel	4.9	1433832
PG-C ALST 4,8X17,0 F "CE"	17.0	4.8	6.5-13.0	Aluminium	Steel	4.9	1433833
PG-C ALST 4,8X25,0 F "CE"	25.0	4.8	11.0-19.5	Aluminium	Steel	4.9	1433838
PG-C ALST 4,8X15,0 F "CE"-RAL9006	15.0	4.8	4.5-11.0	Aluminium	Steel	4.9	1642887
PG-C ALST 4,8X15,0 F "CE"-BS10A05	15.0	4.8	4.5-11.0	Aluminium	Steel	4.9	1381901
PG-C ALST 4,8X15,0 F "CE"-RAL9010	15.0	4.8	4.5-11.0	Aluminium	Steel	4.9	1382342
PG-C ALST 4,8X15,0 F "CE"-RAL7016	15.0	4.8	4.5-11.0	Aluminium	Steel	4.9	1381516
PG-C A2A2 4,8X10,0 F "CE"	10.0	4.8	1.0-6.5	SS A2	SS A2	4.9	1433914
PG-C A2A2 4,8X15,0 F "CE"	15.0	4.8	5.0-10.0	SS A2	SS A2	4.9	1433915
PG-C A2A2 4,8X17,0 F "CE"	17.0	4.8	8.0-12.0	SS A2	SS A2	4.9	1433916
PG-C STST 4,8X10,0 F	10.0	4.8	1.5-6.5	Steel	Steel	4.9	1433873
PG-C STST 3,2X 8,0 F (GSMD41-43SPG)	8.0	3.2	1.0-5.0	Steel	Steel	3.3	1433866

PG-C	ALA2	5,0	18,0	F	K14,0	CE	RAL9010
<b>PG-C = PolyGrip®</b>	<b>Body material Mandrel material</b>	<b>Body diameter (mm)</b>	<b>Body length (mm)</b>	<b>Head shape</b> F=flat dome   S=countersunk KK=small head   RK=round head	<b>Max. head diameter (mm)</b>	<b>CE marked</b>	<b>Painting (optional)</b>

### Fastener material guide

ST = Steel  
 AL = Aluminium  
 A2 = Stainless Steel A2  
 A4 = Stainless Steel A4